

The Septic System Program Permitting Process and Programs Managed by the Septic System Program

by Daniel LaRubio, Jr., P.E.

AUGUST 20, 2018



The Septic System Program Permitting Process and Programs Managed by the Septic System Program



1. Individual Sewage Disposal Systems (ISDS) for Residential, Commercial and Commercial Holding Tanks
2. Liquid Waste Haulers (LWH)
3. Used Mattress Plan Reviews and Operations
4. New Mobile Home Parks (MHP) Plan Reviews
5. New RV Parks (RVP) Plan Reviews
6. New Public Accommodations (PA) Plan Reviews

The Septic System Program Permitting Process



Documents Required:

1. Parcel Map - filed for existing septic system at Planning Department (Jurisdiction Dependent)
2. Water Authority Will-Serve Letter or
 - ▶ Nevada State Division of Water Resources Well Log
3. Sewer Authority Letter stating municipal sewer is not available for connection within 400' to the nearest property line (Jurisdiction Depended)

The Septic System Program Permitting Process and Programs Managed by the Septic System Program - Challenges

- ▶ We frequently are given **incomplete** Application Submittals.
- ▶ Design Plans may not be to scale.
- ▶ The indicated design may be in error and require staff input to correct.
- ▶ The sizing of required components may be marginal.
- ▶ Lack of a Deed for their property is significant.
- ▶ Lack of an appointment will require more attention.



Nitrogen Removal Septic Systems Permitting Process:



Documents Required:

1. Parcel Map
2. Will-Serve Letter or Well Log
3. Sewer Authority Letter
4. **NDEP Letter** Nitrate Removal Septic System for subdivisions

Nitrogen Removal Septic Systems Permitting Process



ISDS must have a Nitrogen Removal Component in areas where the Septic Density exceeds the allowable limit for the basin.

285 Parcels Highlighted in yellow permitted for a septic system within a square mile of parcel

1 Well within 600' of Parcel 17706306001

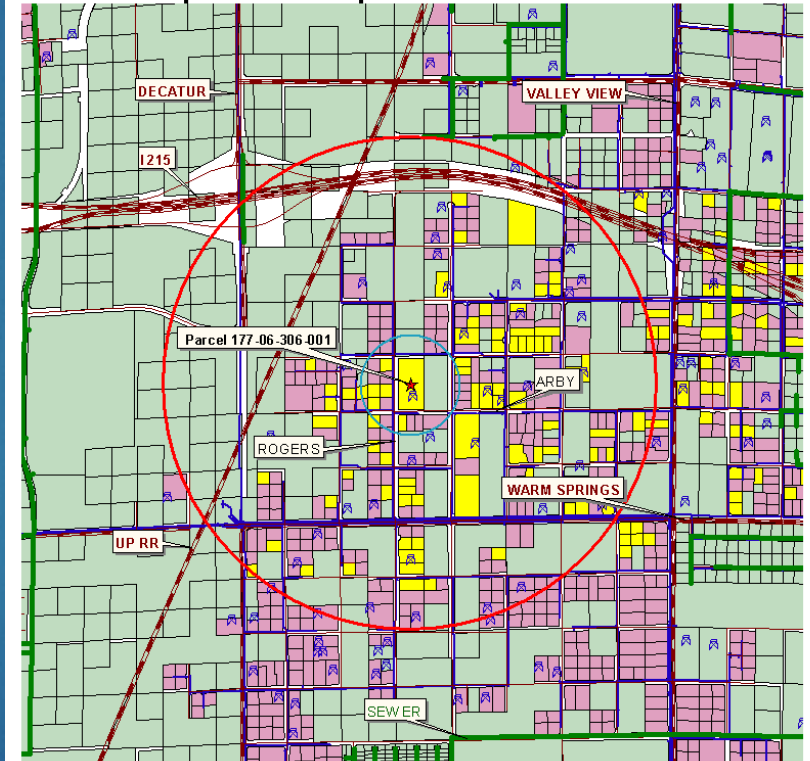

- Swsys_l.shp
- STREETS Streets_l.shp
- LVVWD Pipes_l.shp
- WELLS Wells_x.shp
- SEPTIC SYSTEMS Septic_p.shp
- Sclmajor_l.shp
- Parcel_aox_may02.shp



10/06/03

Liquid Waste Hauler (LWH) Permitting Process



The Regulations Governing Individual Sewage Disposal Systems and Liquid Waste Management also regulate **Liquid Waste Hauler (LWH)** trucks and businesses.

1. Permit Application Requirements:
 1. Vehicle Registration
 2. Business License from applicable jurisdiction
 3. Vehicle Inspection by SNHD staff
 4. Permit expiration one-year



The services that Liquid Waste Haulers provide are the pumping and disposal of Septic Tanks, Port-a-toilets, sand-oil-water interceptors and Grease Interceptors. Also, yellow grease is pumped and sold as a commodity.

Used Mattress Program Permitting Process



A Registration based on the SNHD Regulations Governing the Sanitation and Safety of Used Mattresses and Bedding

Documents Required:

1. Business License from applicable jurisdiction
2. Deed or Lease Agreement
3. Operational Plans for Disinfection/Sanitation
4. Warehouse Configuration Plan
5. Process Flow Diagram
6. List of chemicals and/or equipment
7. Facility Sanitation Plan
8. A Copy of the Law Labels

9. An SNHD Inspection Approval is a Requirement prior to a Registration

New Mobile Home Parks (MHP) and Recreational Vehicle Parks (RVP) Permitting Process



MHP Health Permit NAC 461A

RVP Health Permit based on NAC 444.546

Documents Required:

1. Land Use from Planning Commission and County Commission based on Applicable Jurisdiction
2. Business License based on Applicable Jurisdiction
3. Water Will Serve Letter from Water Authority of Applicable Jurisdiction
4. Sewer Will Serve Letter from Sewer Authority of Applicable Jurisdiction

Requirements for Application:

1. Utility Plans, Fire Protection Plans and Grading Plans for the Site
2. Site Plan showing location and number of spaces and laundry rooms
3. If the property is served by a septic system and/or well, a complete design is required.
4. Location of pools and sewer/water connections
5. Location of signs and trash enclosures
6. Location of sewer, water and power points of connection

New Public Accommodations (PA) Permitting Process



- ▶ PA Health Permit - NAC 447

- ▶ Documents Requirement:
 1. Land Use from Planning
 2. Business License
 3. Water Commitment from Water Authority

- ▶ Application Information required:
 1. Building Plans for Mechanical, Plumbing and Electrical
 2. Air handling calculations
 3. Site drainage/grading plan
 4. Sewage and water disposal requirement calculations
 5. General Facility Safety



Hotel Review of Utilities and HVAC units

The Septic System Program Permitting Process and Programs Managed by the Septic System Program



- ▶ Contacts:
- ▶ Daniel LaRubio, Jr., P.E., REHS, Engineer/Supervisor 702-759-0617
- ▶ Mallory Jett-Edwards, Senior Admin Assistant 702-759-0660

The Septic System Program Permitting Process and Programs Managed by the Septic System Program



Questions?
Thank you!